

Torch head

DIX TETZ 400 L

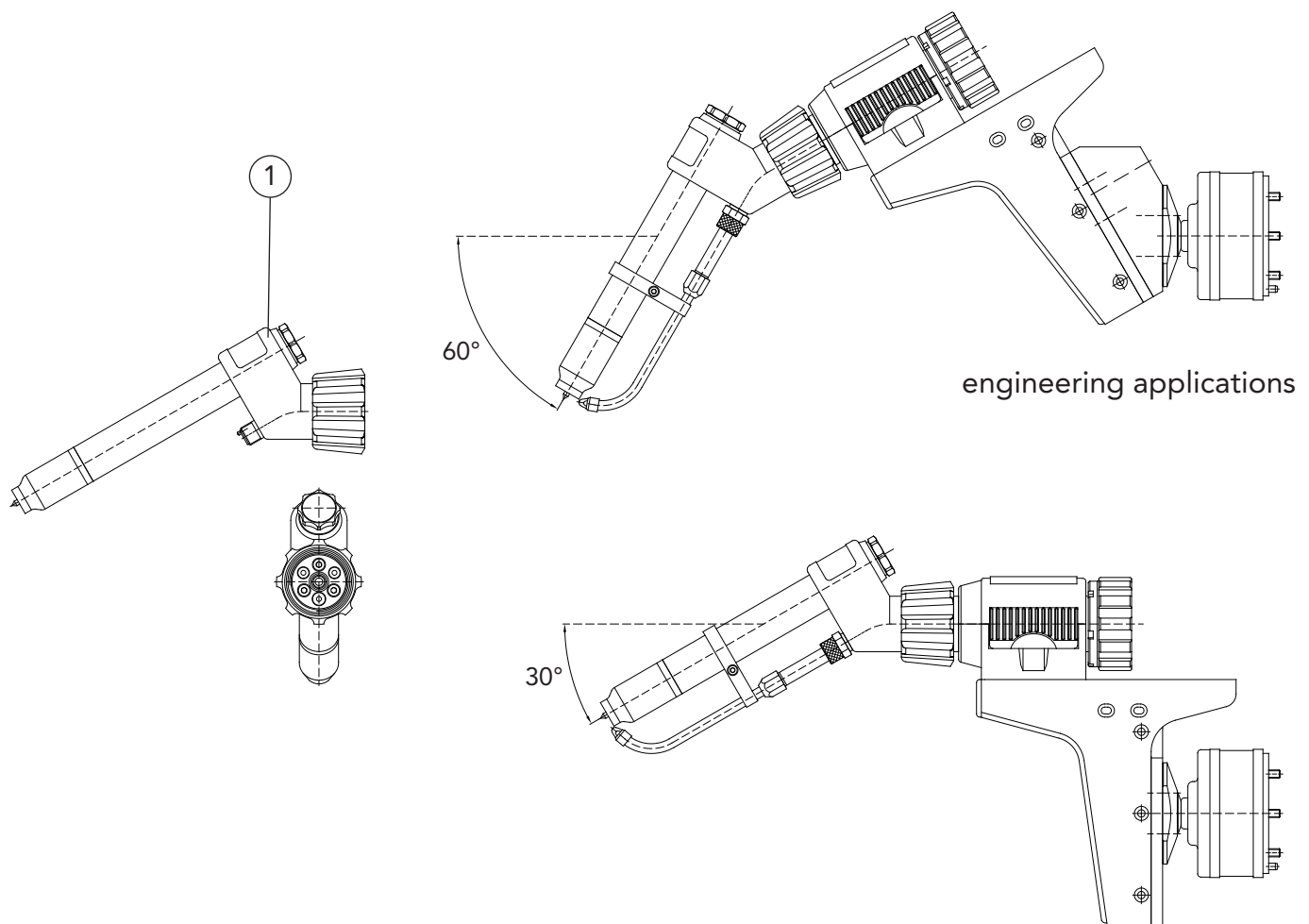

subject to change!

ZBGB-TETZ400-KDZ400-001\K07

Pos.	Description	Part number	Article number
1	Torch head, compl., left (Version turned by 180°) Version 30°, TCP: 410 mm to robotic flange (offset, vertical: 58 mm) Version 60°, TCP: 432 mm to robotic flange (offset, vertical: -100 mm) (Electrode stand out: 5 mm).	DIX TETZ 400 L	641 140 002

- ▶ Standard equipment for electrode diameter 3,2 mm with gas nozzle diameter 12,5 mm, DIX GD 408. Use the special spanner DIX SLAT 2 to fix the torch heads. Variants deviating of the accessories on request.



Torch head

DIX TETZ 400 (L)

Cold wire sets

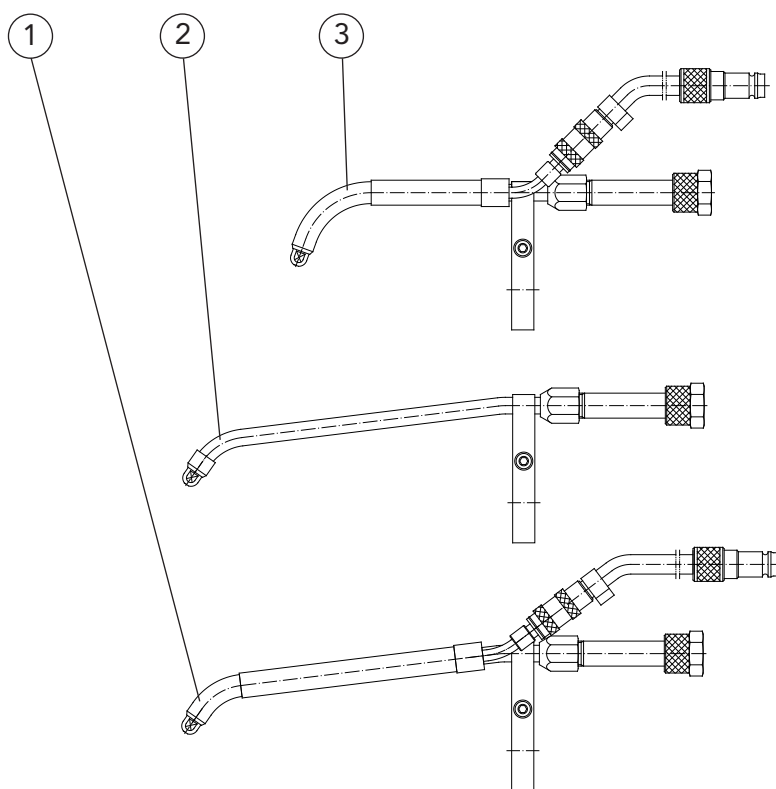

subject to change!

ZBGB-TETZ400-KDZ400-001\K04

Pos.	Description	Part number	Article number
1	Cold wire set, liquid cooled, compl. (standard equipment for wire diameter 1,0 mm and gas nozzle DIX GD 405 L, water hoses 5,0 m)	DIX KDZ 400/001	648 540 002
2	Cold wire set, compl. (standard equipment for wire diameter 1,0 mm and gas nozzle DIX GD 405 L)	DIX KD 400/002	648 540 020
3	Cold wire set, liquid cooled, compl. (standard equipment for wire diameter 1,0 mm and gas nozzles DIX GD 406/408/412, water hoses 5,0 m)	DIX KDZ 400	648 540 003

- For liquid cooling use cooling unit DIX UK 500 (article number: 720 000 002). For more informations to the cooling unit see the standard fittings. Variants deviating of the accessories on request.

