

Torch heads

long
short

DIX MWS 1 - 230 45°

DIX MWL 1 - 230 45°

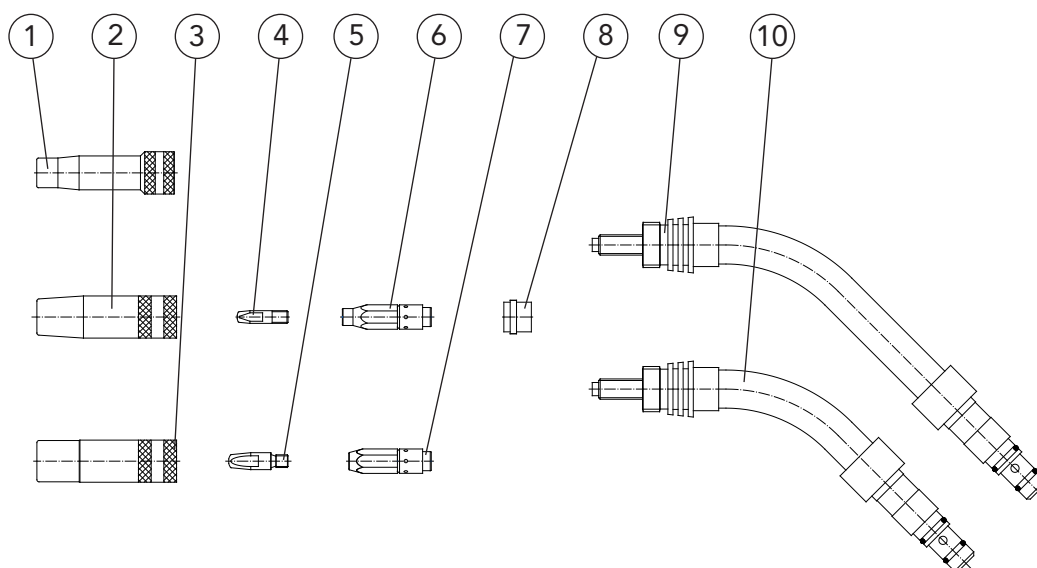

Pos.	Description	Dimension	Part number	Article number
1	Gas nozzle	ø11 mm	DIX 1 - 1 - 311 TRR	619 010 611 0
2	Gas nozzle	ø13 mm	DIX 1 - 1 - 312 TR	619 010 312 0
3	Gas nozzle	ø16 mm	DIX 1 - 1 - 316 TR	619 010 316 0
4	Contact tip	M6	DIX 3 - 1 - xx	619 030 0xx
	Contact tip	CR - ZR M6	DIX 3 - 1 - xx CR - ZR	619 033 0xx
5	Contact tip	M6	DIX 3 - 2 - xx	629 030 0xx
	Contact tip	CR - ZR M6	DIX 3 - 2 - xx CR - ZR	629 033 0xx
6	Tip adapter	M6	DIX 4 - 1 - L	619 040 020
7	Tip adapter	M6	DIX 4 - 1 - K	619 040 010
8	Insulating sleeve		DIX 10 - 1 - 222	619 100 202
9	Torch neck	45° long	DIX 6 - 1 - 230 WS 45°	619 060 723 54
10	Torch neck	45°short	DIX 6 - 1 - 230 WL 45°	619 060 723 44

xx - Standard diameter: 0,8 mm, 0,9 mm and 1,0 mm. Other diameters on request.

subject to change!

ELGB-MWS-MWL1-230\K03

