

Standard fittings

MANUAL WELDING TORCHES

gas cooled

MIG/MAG



DINSE

Singly separable version

DIX MDW 2 - 300

Torch heads

long
short

DIX MWS 1 - 230 45°

DIX MWL 1 - 230 45°

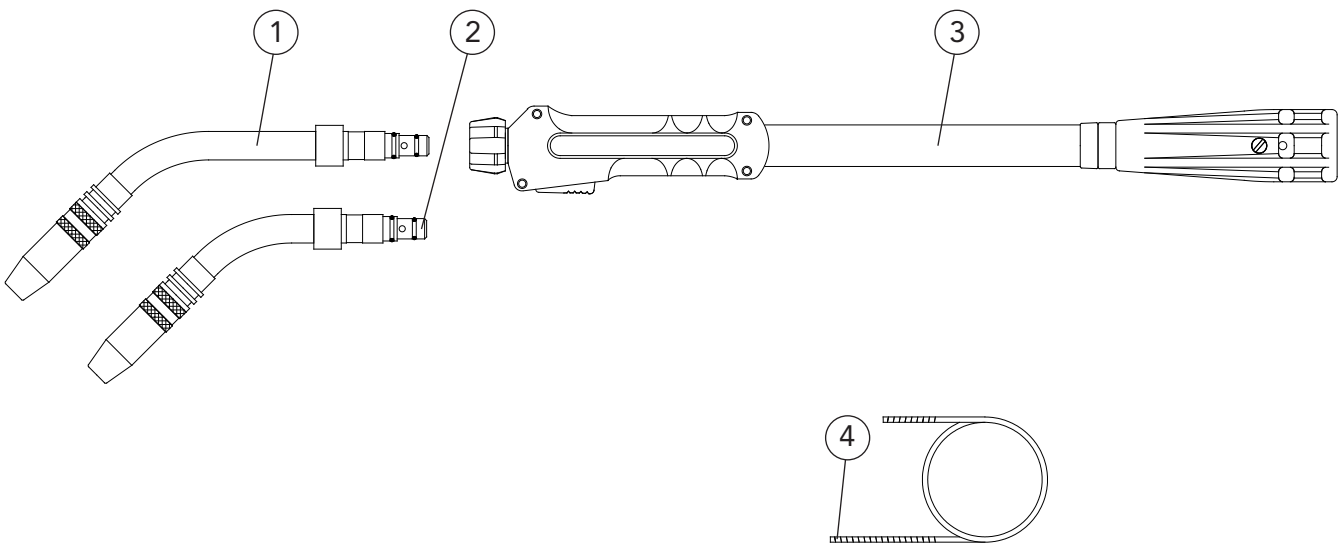

Pos.	Description	Dimension	Part number	Article number
1	Torch head	45° long	DIX MWS 1 - 230 45°	611 077 235 4
2	Torch head	45° short	DIX MWL 1 - 230 45°	611 077 234 4
3	Torch set, without torch head	3,00 m	DIX MDW 2 - 300 - 3	620 047 330
	Torch set, without torch head	4,00 m	DIX MDW 2 - 300 - 4	620 047 340
4	Liner	∅ 1,8mm/ 3,5 m	DIX DS 4/1,8 - 3,5	613 000 235
	Liner	∅ 1,8mm/ 4,5 m	DIX DS 4/1,8 - 4,5	613 000 245

► Standard equipment for wire diameter 1,0 mm steel with gas nozzle diameter 13 mm, DIX 1-1-312 TR, (contact tip DIX 3-1-1,0, set back, tip adapter DIX 4-1-L).
Variants deviating of the standard fittings on request.

subject to change!

SEGB-MDW2-300/K03

