

Standard fittings

ROBOTIC and AUTOMATIC TORCHES

liquid cooled

TIG



DINSE

Fixed version

DIX TAZ 400 ZAW

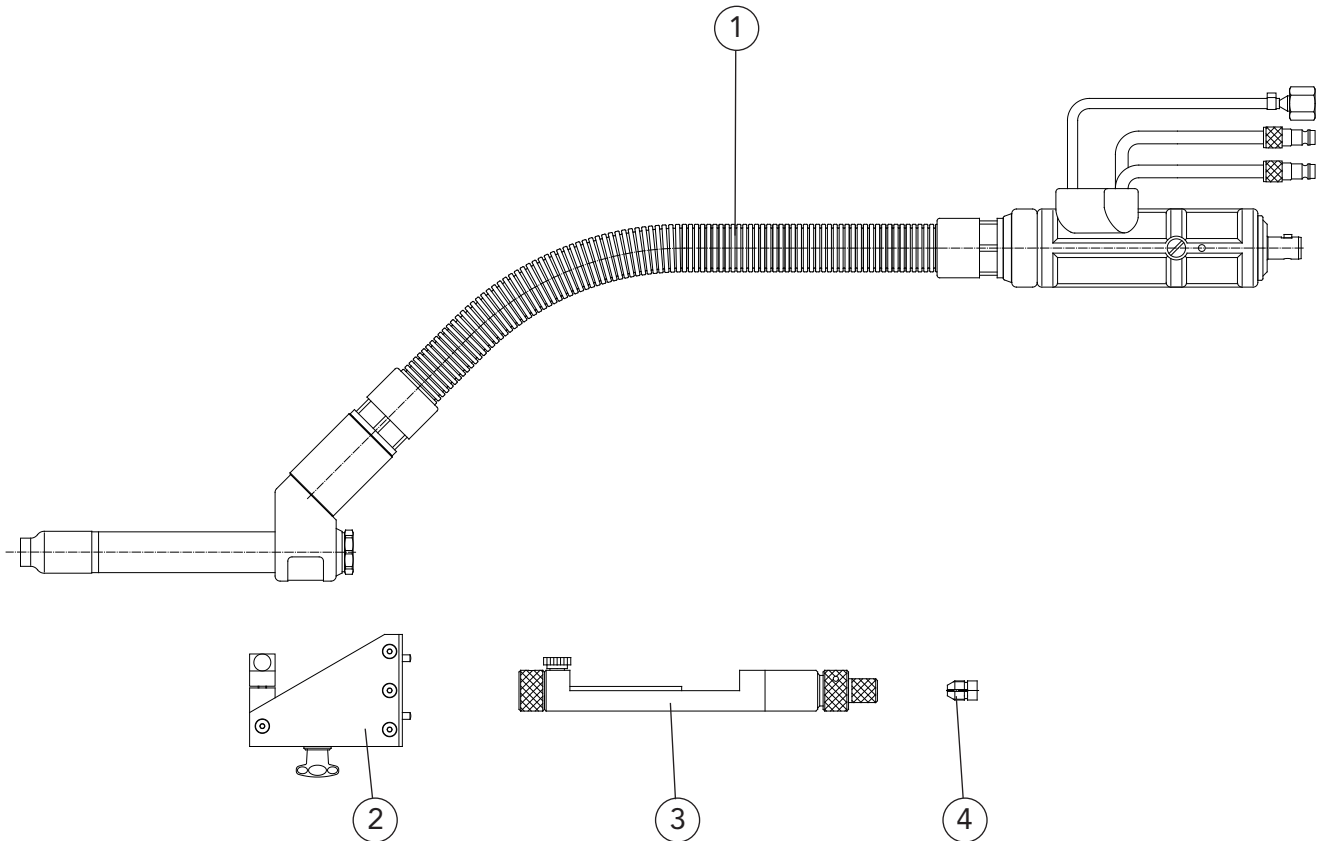

subject to change!

SEGB-TAZ400\K04

Pos.	Description	Dimension	Part number	Article number
1	Torch set	0° 5,0 m	DIX TAZ 400 - 5,0 ZAW	640 500 415 0
	Torch set	0° 7,0 m	DIX TAZ 400 - 7,0 ZAW	640 500 417 0
2	Bracket		DIX PHAT 4 - 0400	648 195 040 0
3	Adjusting gauge		DIX EL 400	648 020 000 0
4	Clamping sleeve (for presetting of the electrode with adjusting gauge)		DIX SH 400 - 3,2	648 050 032 0

- Standard equipment for electrode diameter 3,2 mm with gas nozzle diameter 12,5 mm, DIX GD 408. Variants deviating of the standard fittings on request.

